

SUMNER

EXPANSION PLUG KIT



Nylon Expansion Plugs are ideal for pipe work leak testing of drains, pools, spas and purging.

Nylon construction and natural rubber rings are resistant to many chemicals and sea water corrosion.

Includes ABS case, foam insert, 2 each 3/4" (19 mm), 1" (25.4 mm), 1-1/4" (31.7 mm), 1-1/2" (38.1 mm), 2" (50.8 mm), 2-1/2" (63.5 mm), 3" (76.2 mm), 3-1/2" (88.9 mm), 4" (101.6 mm) plugs and 1 each 10 mm and 3/8" (9.525 mm) barbs.

Part Number	Description
786055	Nylon Expansion Plug Kit



INDEPENDENT WHOLESALE WELDING SUPPLY

Ph: 02 8834 2400 Fax: 02 8834 2498 Email: iwws@iwws.net Website: www.iwws.net

**The hoist for
all fab shop
needs!**

- ✓ 1000 lb (450 Kg), 7 foot (2.1 m), lifting capacity
- ✓ Moves loads vertically and horizontally at the same time
- ✓ Sumner-built single-speed winch offers infinite positioning for accurate fit-ups
- ✓ 8" casters (200 mm) and special base allows load to "get close to the work"
- ✓ Accessories make Fab-mate extremely versatile
- ✓ Priced for all budgets



Capable of lifting
20' lengths (6.0 m)
of 10" pipe



Position fittings with
Sumner Adjust-A-Fit



Align flanges with
Sumner Adjust-A-Flange



Move plate with
plate lifting clamp

Part No.	Description	Height		Width		Length		Weight	
		inch	cm	inch	cm	inch	cm	Lb	Kg
783900	Fab-mate	88.5	224	35	89	44	111	206	93



FAB BOLTS

FLANGE ALIGNMENT BOLTS



Safe, fast, and effective solution for even the toughest flange alignment jobs.
The tool's tapered shaft eliminates hammering and prying when lining up flange bolt holes.

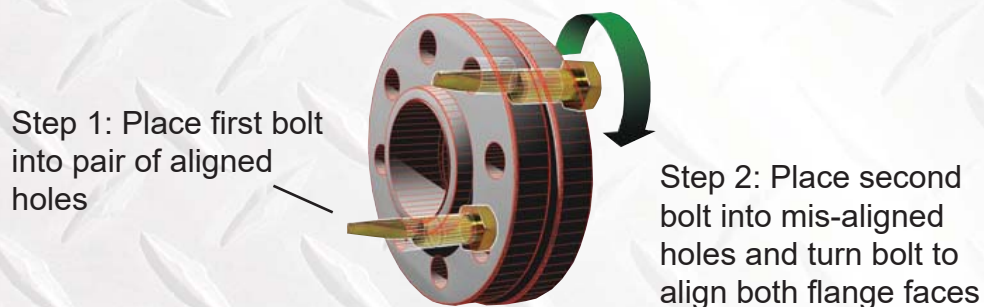

Part Number	Description
FABKIT	FAB Kit Containing 1 set of: 19 mm, 22 mm, 25 mm, 35 mm, 70 mm and 41 mm (3/4", 7/8", 1", 1 1/8", 1 1/4" and 1 3/8")



INDEPENDENT WHOLESALE WELDING SUPPLY

Ph: 02 8834 2400 Fax: 02 8834 2498 Email: iwws@iwws.net Website: www.iwws.net

PIPE WELDING

FLANGE SQ



- 3 points of centering T-square effect (4-90 degree angles)
- Tri-square effect
- Handle-like squaring
- Regular squaring
- Measures height and depth simultaneously
- Squares pipe flanges in two moves
- Ability to square around an over-hanging edge
- Only available in metric

Part Number	Description
6629	Flange square metric

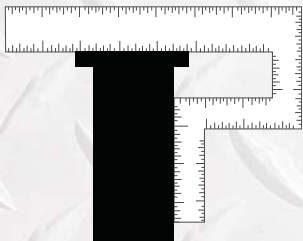

Measuring Pipe fitting

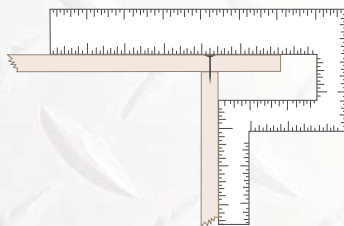

Measuring heights and depths

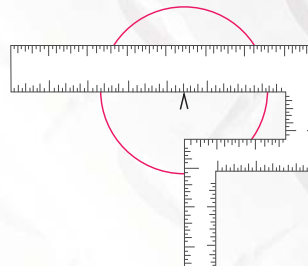

Measure and mark 3 work points in one step on your projects

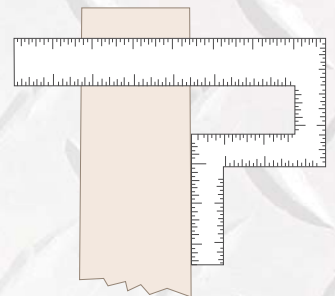

Regular squaring and straight line cut marking



INDEPENDENT WHOLESALE WELDING SUPPLY

Ph: 02 8834 2400 Fax: 02 8834 2498 Email: iwws@iwws.net Website: www.iwws.net

ALUMINIUM PIPE STOPPER



Aluminium plugs are the ideal tool for sealing pipes for plumbing operations and to avoid the penetration of debris and other contamination in a pipe.

They can also be used as inexpensive purge plugs and for low pressure testing according to British standards.

The natural rubber seals of the standard aluminium plugs are expanded by tightening a wing nut once the plug has been positioned inside the pipe.

Part No	Description
TMASC01	Aluminium Pipe Stopper 40 mm
TMASC02	Aluminium Pipe Stopper 50 mm
TMASC02.5	Aluminium Pipe Stopper 60 mm
TMASC03	Aluminium Pipe Stopper 75 mm
TMASC03.5	Aluminium Pipe Stopper 85 mm
TMASC04	Aluminium Pipe Stopper 100 mm
TMASC04.5	Aluminium Pipe Stopper 115 mm
TMASC05	Aluminium Pipe Stopper 125 mm
TMASC06	Aluminium Pipe Stopper 150 mm
TMASC08	Aluminium Pipe Stopper 200 mm

NITRILE INFLATABLE BLANKING STOPPERS

Designed for Oil and Gas Industry



Inflatable stoppers designed for sealing inside pipes for gas purging and low pressure testing applications manufactured in the UK to ISO standards. These stoppers with multiple uses have been designed with the Oil and Gas industry in mind and are robust but lightweight.

The stoppers are available in Cylindrical form with sizes ranging from 5 cm to 252 cm. The Nitrile Stoppers are resistant to most chemicals, gases and oils as well as having good abrasion resistance.

Constructed with a latex inner bladder, with a nitrile outer case with a coated seam. For additional sealing capabilities these bags are best fitted with foam sealing strips.

All stoppers come ready to use with a 1 meter inflation hose fitted with a Schrader valve (other valves are available).

With rope loops fitted as standard on stoppers over 61 cm and all stoppers have a tolerance of + -5mm from sizes these stoppers are an ideal easy to use capping solution.

Part No	Description
TMNIBS030	Nitrile Inflatable Blanking Stopper

NITRILE INFLATABLE BLANKING STOPPERS

Data Sheet

Stoppers are available in Cylindrical form from size 50 mm (2 inch) to 2525 mm (100 inch). Nitrile Stoppers are resistant to most chemicals, gases and oils as well as having good abrasion resistance.

Construction: Latex inner bladder
Nitrile outer case with coated seams (fabric colour may vary)
12 mm x 8 mm inflation hose (1.2 m)
Schrader Valve/Ball Valve
24" (600 mm) and above have 4 rope loops as standard
Tolerance + or - 5 mm from size
Nitrile closed cell sealing strips

Extras: Rope loops can be added to smaller size stoppers
Longer inflation hose can be fitted
40 mm 0 - 15 PSI Gauge

Inflation Pressure:

Size	PSI
2" - 5"	10
6" - 8"	6
9" - 10"	4
12" - 16"	3
18" - 30"	2
31" - 35"	1.5
36" - 42"	1
43" - 72"	0.5

Hold Back Pressure

Generally un-supported hold back pressure is 20% of the inflation pressure of the stopper.

SOLUSHIM WATER SOLUBLE ALIGNMENT STICKS



SoluShim Water Soluble Alignment Sticks are an innovative solution for maintaining precise gaps on plates, pipes, and flanges as required by AWS codes D1.1 – D1.6, and API 1101 pipe codes.

When SoluShim is placed between a gap, it enables consistent pipe and seam spacing, enhancing the operator's overall efficiency.

The conventional method of forming a root gap involves the use of filler rods. Besides being non-uniform in size and thickness, these welding rods are composed of foreign metals that are incompatible with the base metals being welded.

Removal of these rods is a cumbersome process and typically involves mechanical grinding or torch cutting, both of which are costly and labour intensive and can leave behind trace elements that contaminate the welding area.

SoluShim is compatible with any metal and instantly begins to dissolve when introduced to water. This allows the sticks to be effortlessly removed from the welding fit up, leaving behind no residue that could compromise the weld quality. Compared to metal rods, SoluShim is the superior choice for maintaining precise, even gaps throughout the weld fit-up.

Traditional Method Using Welding Rod



Plate to Plate

Simple Solution Using SoluShim Alignment Sticks

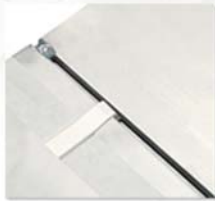

Features and Benefits

Conforms To AWS Code

SoluShim SS-2-38-16 and SS-4-38-16 provide 1/8" minimum gap for plate/pipe projects as required by AWS Code D1.6/D1.6M Stainless Steel Structural Code, eliminating need for measurement and guesswork.

Experience Contaminant-Free Welding

Made from EPA Approved Aquasol Water Soluble Composite Board 100% biodegradable and environmentally friendly

Compatible with any metal

Highly durable, incompressible, pre-sized and uniform in thickness
Flexible structure can be manually shaped to form any angle with ease

Consistent Pipe & Seam Installation

Maintains required root gap during plate and pipe welding applications
Highly Incompressible
Eliminates holding rod while simultaneously welding
Eliminates root gap from shrinking with each tack weld
Sticks stay firmly in place throughout welding process

Simple Spacer Removal

Removal is fast and effortless using a light application of water to moisten and dissolve sticks, achieving a contaminant free weld
Leaves behind no harmful trace elements that can lead to post-weld contamination. Eliminates costly and timely post-weld grinding to remove metal spacers
Spacer Installation & Removal



Pipe to Flange



Pipe to Pipe



How SoluShim Works

Spacer Installation & Removal

Equally space SoluShim Water Soluble Alignment Sticks between seams of metal components to be welded.
Bend SoluShim sticks to form a 90° angle if preferred or if required by application (i.e. pipe-to-pipe fit up).

Align the components to be welded.

Tack-weld the joints in the area between the alignment sticks.
Be sure to avoid charring alignment sticks or tape when tack-welding.

After welding is complete, introduce water to safely moisten and dissolve alignment sticks for easy, fast removal.
Wait roughly 10 seconds after introducing water.
Then simply pull SoluShim sticks from between the metal components or let them dissolve completely with further application of water.



WATER SOLUBLE PAPER

Self Adhesive Water Soluble Paper

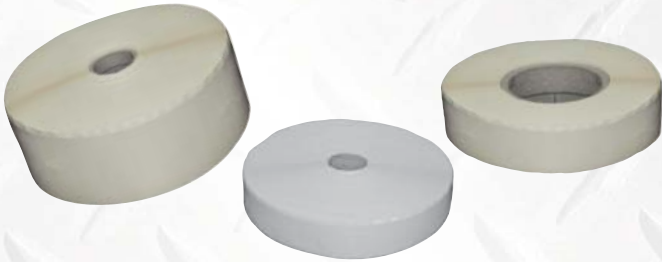

Part Number	Description
TM-2301T	50 MM x 91 M (2" x 298') ROLL
TM-2303T	50 MM x 91 M (2" x 298') ROLL
TM-1301T	25 MM x 91 M (1" x 298') ROLL 25 MM (1") CORE
TM-1303T	25 MM x 91 M (1" x 298') ROLL 76 MM (3") CORE

Light Weight Water Soluble Paper



- Cost effective option for single welds
- Easy set-up and handling
- Soluble in hot and cold water for easy removal

Part Number	Description
TM35-811S	216 MM x 279 MM (8 1/2" x 11") SHEET
TM35-814S	126 MM x 368 MM (4 15/16" x 14 1/2") SHEET
TM35-9165R	225 MM x 50 M (8 7/8" x 164') ROLL
TM35-15165R	375 MM x 50 M (14 3/4" x 164') ROLL
TM40-20165R	500 MM x 50 M (19 11/16" x 164') ROLL

Heavy Weight Water Soluble Paper



- Cost effective option for single welds
- Easy set-up and handling
- Soluble in hot and cold water for easy removal

Part Number	Description
TM60-1522S	394 MM x 559 MM (15 1/2" x 22") SHEET
TM60-15165R	394 MM x 50 M (15 1/2" x 164') ROLL
TM60-31165R	787 MM x 50 M (31" x 164') ROLL



PURGE BAFFLE KITS



Purge Baffles for High-Purity Tube & Pipe Welding

Durable tube and pipe baffle systems are designed for quick, cost effective purging of popular pipe and tube diameters and schedules. They're engineered to reduce time spent purging a run of pipe, and greatly decrease labor costs, and save you money on expensive argon shield gas. Most importantly, purge baffles are proven to improve tube and pipe weld quality.

Based on your application, choose between our heavy-duty, dedicated Purge Baffles designed for a single pipe diameter, or choose a versatile Modular Baffle System which includes a variety of interchangeable parts that can be customized to handle all of the pipe diameters and schedules that come your way.

Part No.	Size
AZPK3843	38-43 mm
AZPK4348	43-48 mm
AZPK4753	47-53 mm
AZPK5258	52-58 mm
AZPK5463	54-63 mm
AZPK5868	58-68 mm
AZPK6472	64-72 mm
AZPK6876	68-76 mm
AZPK7281	72 - 81 mm
AZPK7586	75-86 mm

Part No.	Size
AZPK8091	80-91 mm
AZPK8695	86-95 mm
AZPK90101	90-101 mm
AZPK100112	100-112 mm
AZPK105120	105-120 mm
AZPK120140	120-140 mm
AZPK135155	135-155 mm
AZPK145165	145-165 mm
AZPK160180	160-180 mm
AZPK175200	175-200 mm

Part No.	Size
AZPK195220	195-220 mm
AZPK215240	215-240 mm
AZPK235260	235-260 mm
AZPK255280	255-280 mm
AZPK275300	275-300 mm
AZPK290320	290-320 mm
AZPK310340	310-340 mm
AZPK325355	325-355 mm
AZPK345375	345-375 mm
AZPK360390	360-390 mm
AZPK380410	380-410 mm



INDEPENDENT WHOLESALE WELDING SUPPLY

Ph: 02 8834 2400 Fax: 02 8834 2498 Email: iwws@iwws.net Website: www.iwws.net



PURGE BAFFLE ASSEMBLY



Step 1: Assemble the inlet to what will be your forward baffle. Insert the threaded portion of the gas inlet through the centre hole of the baffle and secure with the nut.



Step 2: Assemble the outlet to what will be your trailing baffle. Like with the forward baffle, insert the threaded portion of the gas outlet through the centre hole of the baffle and secure with the nut.



Step 3: With both baffles assembled, affix the first of the connecting arms to the forward baffle.

Note: Deciding whether to use the flexible arms or the rigid arms in your application depends on the types of bends in the pipe run.

a) Straight pipe: Use both rigid arms.

b) Moderate - std elbows: Use 1 rigid arm as the forward connector and 1 flexible arm as the trailing connector.



Step 4: Then, thread the diffuser onto each of the connecting arms.



Step 5: Connect the trailing baffle to the trailing connecting arm.

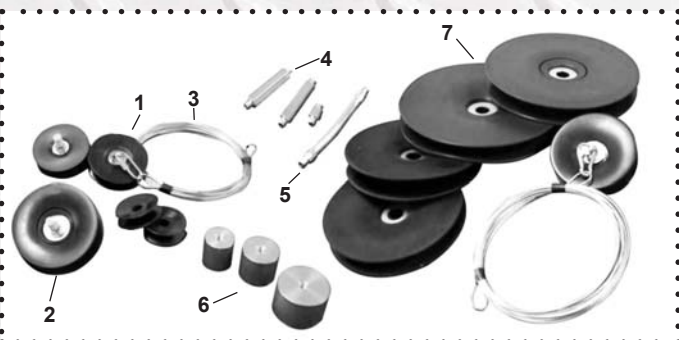

Kit includes:

1. Gas inlet with nut & safety hook
2. Gas outlet with nut & sintered excess pressure vent
3. 9 m pull cable & 9 m gas hose with quick disconnect
4. Ridge arms 2 x medium, 1 x short
5. Flexible arm x 1
6. Gas diffuser x 1
7. Silicon baffles x 2



INDEPENDENT WHOLESALE WELDING SUPPLY

Ph: 02 8834 2400 Fax: 02 8834 2498 Email: iwws@iwws.net Website: www.iwws.net

RING PURGE SYSTEMS



- Cuts down considerably on purge gas and time by reducing pipe length and pipe diameter that needs purging.
- Pre-set non-tamper valves minimise risk of bursting of dams.
- Available for pipe diameters between 8" to 80" (20 to 203 cm).
- Heat-covered version available upon request for use in pre-heated pipes (350°C).
- 100°C temperature rating. On standard models.

Part No	Description
TMRP008	Ring Purge 8" (200 mm)
TMRP012	Ring Purge 12" (300 mm)
TMRP014	Ring Purge 14" (350 mm)
TMRP016	Ring Purge 16" (400 mm)
TMRP018	Ring Purge 18" (450 mm)
TMRP020	Ring Purge 20" (500 mm)
TMRP026	Ring Purge 26" (650 mm)
TMRP028	Ring Purge 28" (700 mm)

Part No	Description
TMRP030	Ring Purge 30" (750 mm)
TMRP032	Ring Purge 32" (800 mm)
TMRP036	Ring Purge 36" (900 mm)
TMRP040	Ring Purge 40" (1000 mm)
TMRP044	Ring Purge 44" (1100 mm)
TMRP054	Ring Purge 54" (1350 mm)
TMRP056	Ring Purge 56" (1400 mm)
TMRP060	Ring Purge 60" (1500 mm)

HEAT RESISTANT INFLATABLE PIPE PURGING SYSTEM

Designed for use in pipe welding at high temperatures. Such as pre-heated pipework and pipes where very high temperatures are required.

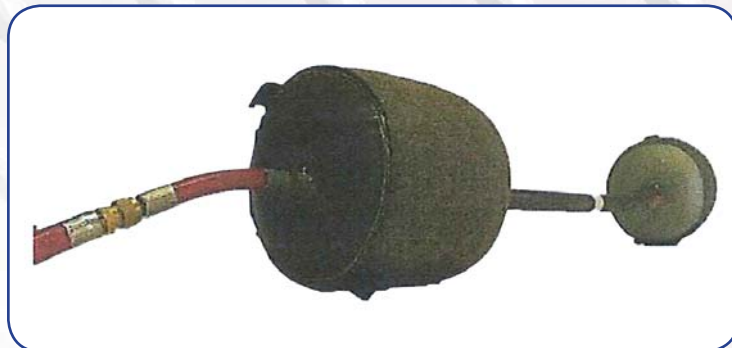
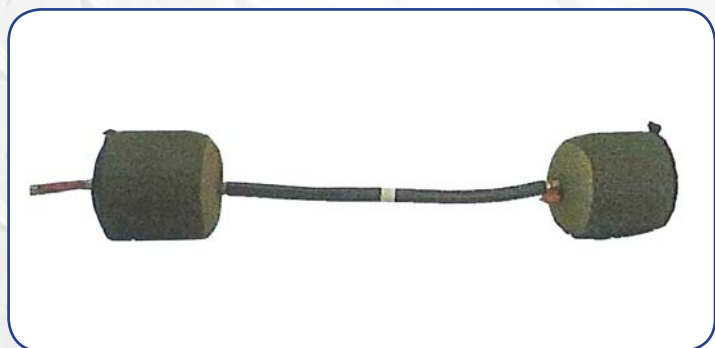

- Tigmaster Heat Resistant Purge Systems have cylindrical inflation dams connected by 1 meter of high grade insulated spinal hose. For use when pre-heating pipes 350° continuous 500° short terms.
- Easy to operate; connect the red hose to a dedicated and regulated gas supply. Purge up to 20 litres per minute through the pre-set purge valve.
- Pull or push the purge system into position using the rope loops. Simple to locate by looking through the root gap using the central silicon strip.
- Lightweight and collapsible. Available from 50mm - 2" to 175mm -7" in 25mm/1" increments. For larger sizes use Tigmaster Heat Resistant Ring Purge System.

Part Number	Description
TMHRPS004	Heat Resistant Purge Bags 4"/100 mm
TMHRPS008	Heat Resistant Purge Bags 8"/200 mm
TMHRPS014	Heat Resistant Purge Bags 14"/350 mm
TMHRPS018	Heat Resistant Purge Bags 18"/450 mm

INFLATABLE PURGE SYSTEM

Especially insulated heat covered inflatable purge system for purging applications in pre-heated pipes can be supplied upon requested



- Made from fire-retardant “Flameshield” proban cotton for increased resistance to damage from scorching and burning.
- Armoured, robust connection hose.
- Bypass hose for additional gas inlet/exhaust.
- Reinforced stitching and crimping for improved tear-resistance.
- Strong eyelet pull loops.
- Reduces flow rate during hot passes to 5 to 10 lpm.
- Available for pipe diameters from 2” to 96”.
- Special hose barb connections available for easy connection to gas source.

Part No	Description
TMIPS002	50 mm Inflatable Purge Dam
TMIPS003	75 mm Inflatable Purge Dam
TMIPS004	100 mm Inflatable Purge Dam
TMIPS005	120 mm Inflatable Purge Dam
TMIPS006	150 mm Inflatable Purge Dam
TMIPS008	200 mm Inflatable Purge Dam
TMIPS010	250 mm Inflatable Purge Dam
TMIPS012	300 mm Inflatable Purge Dam

Part No	Description
TMIPS014	350 mm Inflatable Purge Dam
TMIPS016	400 mm Inflatable Purge Dam
TMIPS018	450 mm Inflatable Purge Dam
TMIPS020	500 mm Inflatable Purge Dam
TMIPS022	550 mm Inflatable Purge Dam
TMIPS024	600 mm Inflatable Purge Dam
TMIPS026	650 mm Inflatable Purge Dam
TMIPS028	700 mm Inflatable Purge Dam

Part No	Description
TMIPS030	750 mm Inflatable Purge Dam
TMIPS032	800 mm Inflatable Purge Dam
TMIPS034	850 mm Inflatable Purge Dam
TMIPS036	900 mm Inflatable Purge Dam
TMIPS040	1000 mm Inflatable Purge Dam
TMIPS048	1200 mm Inflatable Purge Dam
TMIPS052	1300 mm Inflatable Purge Dam

Option: No shadow x-ray clear hose

Part No	Description
TMPTFE1000	Non metal purge bag hose 1 m
TMPTFE500	Non metal purge bag hose 1/2 m



OPERATION OF INFLATABLE PURGE SYSTEM

Step 1

The deflated Purge System can be easily placed in the pipe by using the pull tags.

Step 2

Once the two dams of the Purge System are in position on either side of the weld joint, there is a glowtape in the middle of the dams to advise "in position".

The dams are inflated by opening the argon source to 5-10 lpm flow rate and will quickly seal the pipe.

The pressure will open the purge valve and purging of the space between the pipe and the purge dam begins once dams are inflated.

During purging, the air between the Purge System and the pipe is pushed through the exhausts of the purge system away from the vicinity of the weld until the oxygen level is low enough to start welding, as per the welding procedure.

Use a purge gas monitor to advise oxygen levels.

The Purge System requires a constant flow rate of inert shielding gas of up to 3-5l/min to maintain a positive purge pressure.

Step 3

After completion and the weld has cooled below oxidation temperature the Purge System can be easily deflated by interrupting the argon gas supply. Once deflated remove from the pipe.

Note: For best welding results, use inflatable weld purge together with a weld gas analyser (TMWGA001 or TMSCGA) and aluminium tape to seal the prep areas while purging to reduce gas usage.

Applications

The Purge System can be used whenever welding stainless steel and reactive metal pipework. Also suitable for purging autogenous weld fit ups as well as scheduled pipework that requires a gap between two bevelled pipe ends.

Standard Purge Bags: 100°C

Heat Resistant Purge Bags: 350°C continuous - 500°C short term

MULTI - SIZE INFLATABLE PURGE SYSTEM



- A multi-size purge system that makes an effective seal for purging across wide range of pipe diameters 1.5" - 14" (38 - 355 mm).
- Unique Glide skin sleeve allows it to be pushed or pulled into the pipe and around any bend.
- Can easily be located looking through the root gap using the high intensity luminous strip positioned in the centre of the system
- Ready to use. Connect to a dedicated and regulated gas supply and choose any flow rate up to 15 litres per minute through the pre-set purge valve.
- Lightweight and collapsible.
- Fabricated with Proban cotton faces with a Neoprene core material.
- Central Exhaust System for better external seal, additional hose outlet used for additional gas input.
- 100°C temperature rating.

Part No	Product Size	Size Range	Pipe Sizes Covered	Schedules Covered	Weight
TMMIPS015	1.5" (38 mm)	1.5" - 3.5" (38 - 85 mm)	3	24	0.4 kg
TMMIPS035	3.5" (80 mm)	3.5" - 6.5" (80 - 170 mm)	4	34	0.5 kg
TMMIPS065	6.5" (170 mm)	6.5" - 10.5" (170 - 270 mm)	4	27	0.7 kg
TMMIPS105	10.5" (257 mm)	10.5" - 14" (257 - 355 mm)	4	25	0.8 kg

SUMNER

MAX JAX

- Steel casters now standard
- 1,135 kg Load capacity
- Safely handles pipe up to 90 cm in diameter
- Sturdy 5 leg construction for greater stability



Specifications

Basic Unit	Height: 686 mm Width: 752 mm
Basic Unit with Casters	Height: 927 mm Width: 1,003 mm
Vee-Head Height	Min: 533 mm Max: 838 mm
Vee-Head Height with Casters	Min: 775 mm Max: 1,080 mm



781381



781382



781394



781406



781407



781465

Part Number	Description	Kg
781460	Max Jax- Basic	26.4
781403	Max Jax Kit #1	65.5
781381	Large Roller Wheel Kit	5.5
781382	Stainless Steel Sleeves	2.3
781394	Rubber Wheel Kit	1.8
781406	Roller Head Kit	4.1
781407	Stainless Steel Roller Head Kit	4.1
781465	Roller Wheel Caster Kit (Max Jax)	34.1



781403

Max Jax Kit 781403 includes:

- Basic Max Jax 781460
- Caster Kit 781465
- Roller Head Kit 781406



781460



INDEPENDENT WHOLESALE WELDING SUPPLY

Ph: 02 8834 2400 Fax: 02 8834 2498 Email: iwws@iwws.net Website: www.iwws.net

SUMNER

MAX JAX PARTS

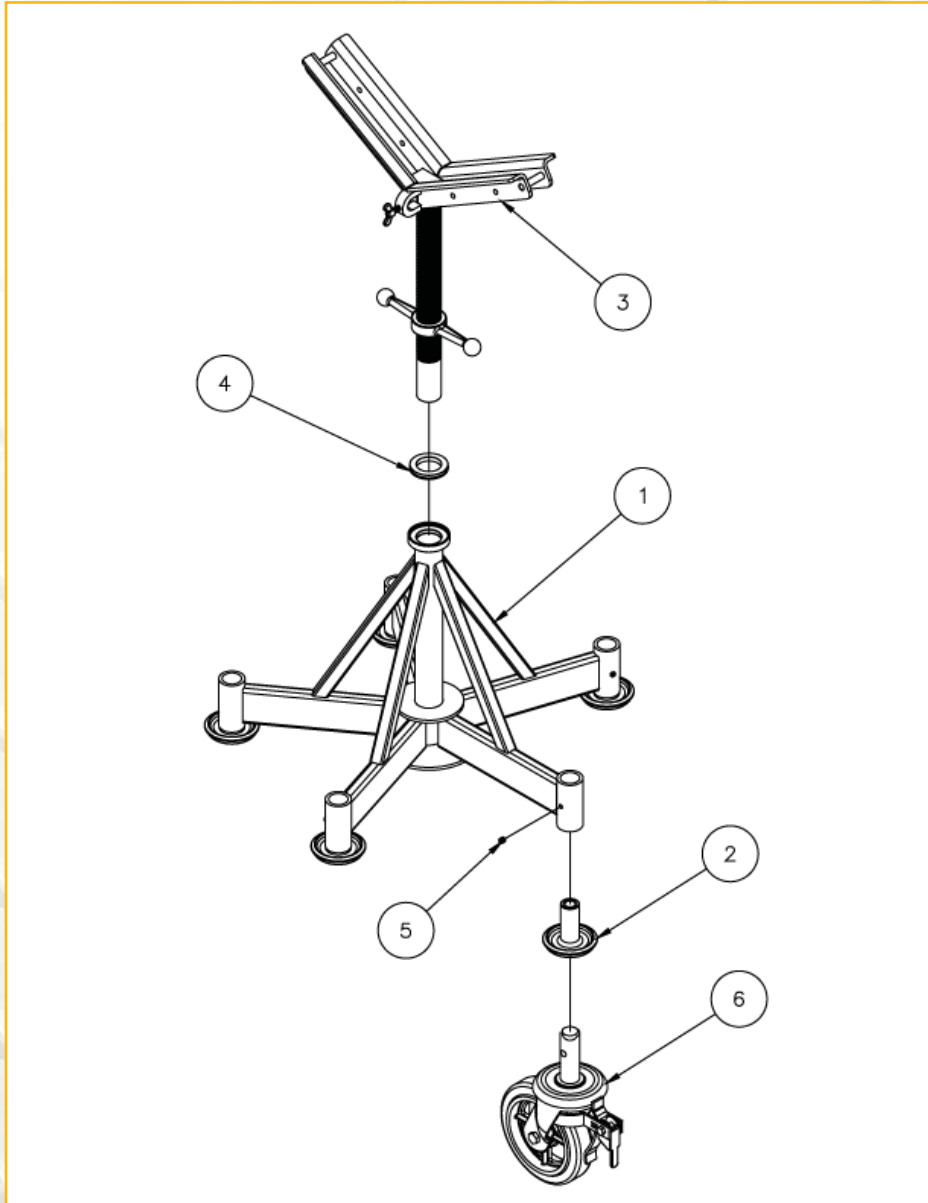

	Part No	Description
1	781459	Base Weldment, Max - Jax (5 Leg)
2	781396	Max Jax Leveling Pad
3	781415	Big Vee Head Assembly W/Spanner Nut
4	781425	Thrust Washer
5	771460	Screw, SHSS 3/8-16 x 3/8" (9.52 - 406.4 x 9.52 mm) Cup PT
6	779023	Caster, Roller Wheel
	781464	Caster Kit (5) Standard
	781465	Caster Kit (5) Steel Casters



INDEPENDENT WHOLESALE WELDING SUPPLY

Ph: 02 8834 2400 Fax: 02 8834 2498 Email: iwws@iwws.net Website: www.iwws.net

SUMNER

MAX JAX 2

- 2045 kg Load capacity
- 106 - 914 mm Pipe capacity
- Base reversible for 584 - 914 mm heights
- Drop slot roller wheel head offers more wheel contact with pipe
- Roll pipe through fab shop



Pictured with optional roller wheels (781381)

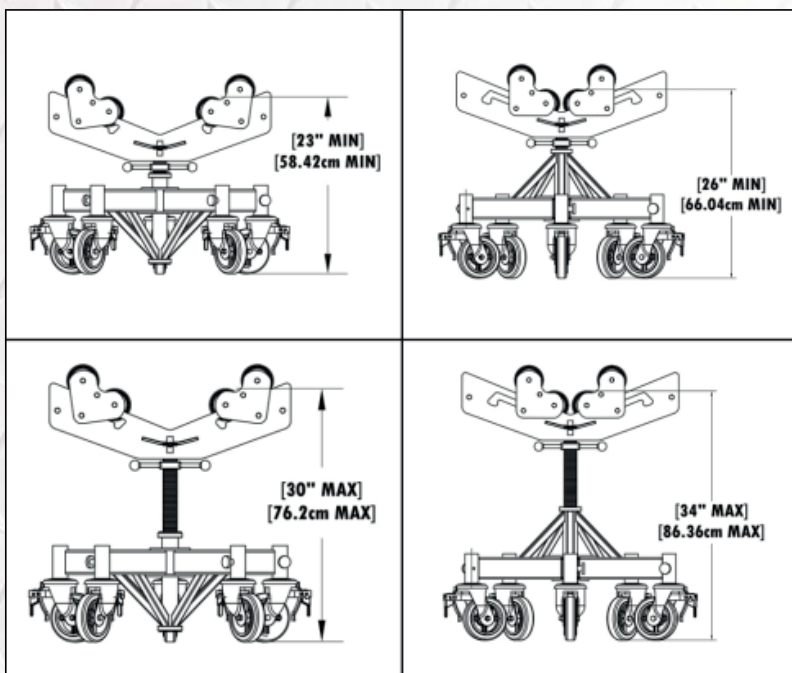

Specifications	
Base Width	953 mm
Max Height	914 mm
Min Height	585 mm
Load Capacity	2045 kg
Pipe Capacity	100 - 900 mm
Max Jax 2 with Drop Slot Rollerhead Weight	57.7 kg
Max Jax 2 with Vee Head Weight	48.3 kg
Thread Shaft Adjustment	178 mm

Part Number	Description
786450	Max Jax 2 with Vee Head
786451	Max Jax 2 with Roller Head

Max Jax 2 786451 comes complete with head, dropslot and 4 roller wheels.



INDEPENDENT WHOLESALE WELDING SUPPLY

Ph: 02 8834 2400 Fax: 02 8834 2498 Email: iwws@iwws.net Website: www.iwws.net

SUMNER

MAX JAX 2 PARTS

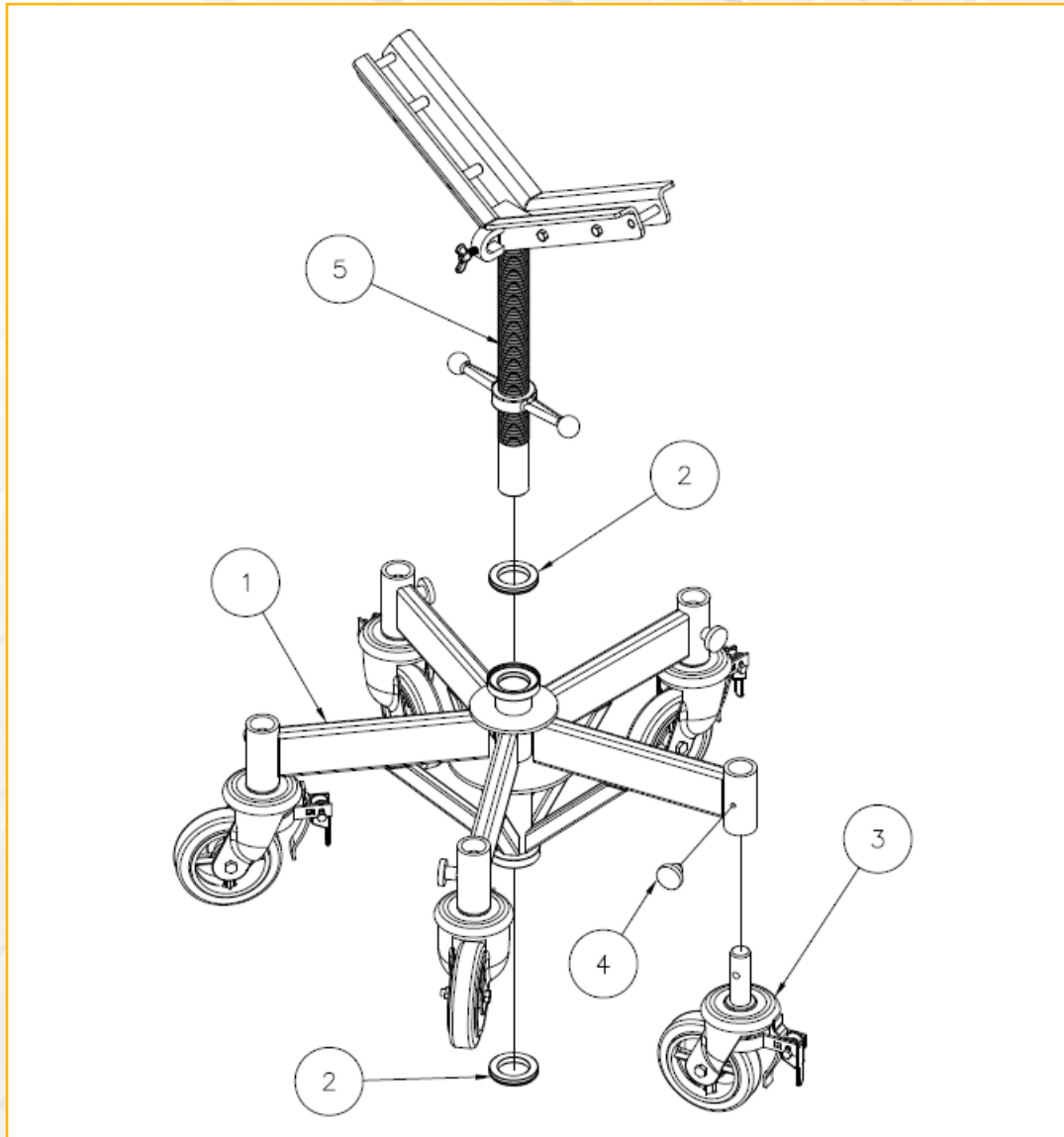

	Part No	Description
1	786455	Max Jax 2 - Base Weldment
2	781425	Thrust Washer
3	779048	Caster, 6" (152.4 mm) Swivel - Max Jax 2
4	786459	Set Screw Assembly, Max Jax 2
5	781417	Big Vee HD Assembly W/Spanner Nut Max Jax 2



INDEPENDENT WHOLESALE WELDING SUPPLY

Ph: 02 8834 2400 Fax: 02 8834 2498 Email: iwws@iwws.net Website: www.iwws.net

EZ TAPE

EZ Tape is a traditional, fully coated aluminium tape that can be used to seal root gaps by controlling the release of gas during purging and to seal pipe ends for transporting.



Fully coated
with
Adhesive

- EZ Tape can act as a purge gas retaining tape, seal pipe ends for transporting, or a vapor barrier for HVAC applications.
- This “All purpose solution” can be used in numerous industries.
- The adaptive nature of EZ Tape enables the aluminium foil to adhere and conform to irregular surfaces including stainless steel and aluminium pipes.
- Pressure sensitive adhesive makes for easy application.
- Adhesive portion withstands temperatures up to 260°C.
- Aluminium foil portion of tape withstands temperatures up to 593°C.

Part Number	Description
EZ-T2.0	Fully Coated Aluminium 51 mm x 23 m



INDEPENDENT WHOLESALE WELDING SUPPLY

Ph: 02 8834 2400 Fax: 02 8834 2498 Email: iwws@iwws.net Website: www.iwws.net

FIBACK FIBERGLASS WELD BACKING TAPE

Fiback Fiberglass Weld Backing Tape is an innovative substitute for traditional back purging methods that provides protection to the backside of the weld environment.



- Eliminates the need for back purging, increasing weld productivity and reducing labor costs.
- Suitable for stainless steel, carbon, duplex and chrome steels as well as other metals.
- Consistent in thickness, Fiback creates a continuous bead, ideal for lengthy applications.
- Saves gas as well as down time, allowing the user to bypass filling large structures; such as pressure vessels and bore pipes with argon.
- Significantly reduces post-weld clean up time.
- Perfectly compatible with orbital welding machines.
- Suitable for SMAW (stick), TIG and MIG welding processes.

Part Number	Description
AFBT-2.5-200	Light Duty Fiback Weld Backing Tape 200 amp 63 mm x 25 m
AFBT-4.0-200	Light Duty Fiback Weld Backing Tape 200 amp 101 mm x 25 m
AFBT-2.5	Heavy Duty Fiback Weld Backing Tape 600 amp 63 mm x 12.5 m
AFBT-4.0	Heavy Duty Fiback Weld Backing Tape 600 amp 101 mm x 12.5 m



INDEPENDENT WHOLESALE WELDING SUPPLY

Ph: 02 8834 2400 Fax: 02 8834 2498 Email: iwws@iwws.net Website: www.iwws.net

TRAILING SHIELDS



CURVED TRAILING SHIELDS

- For welding of internal and external pipes and vessels.
- Suitable for all reactive metals.
- Reduce gas use and weld oxidation.
- Helps produce clean, oxygen-free welds.
- Available for various pipe sizes.

Part No	Description
TMTSC01	Trailing Shield 1.5" (38 mm) Pipe
TMTSC02	Trailing Shield 2" (50 mm) Pipe
TMTSC03	Trailing Shield 3" (76 mm) Pipe
TMTSC04	Trailing Shield 4" (100 mm) Pipe
TMTSC06	Trailing Shield 6" (160 mm) Pipe
TMTSC08	Trailing Shield 8" (200 mm) Pipe



STRAIGHT TRAILING SHIELDS

- Suitable for any sheets and plate metal applications.
- Suitable for all reactive metals.
- Reduce gas use and weld oxidation.
- Helps produce clean, oxygen-free welds.

Part No	Description
TMTSS01	Trailing Shield Flat